



# YALE & TOWNE THE LOCKWORKS

A sophisticated mix of residential and retail offerings, Yale & Towne is situated on the site of the old Yale Lock factory, which for over a century gave Stamford the nickname “The Lock City.”

## NOW OPEN

The Lofts: 225 units 100% leased  
Fairway Market  
Fairway Wine & Spirits  
Design Within Reach Headquarters & Retail Showroom  
Williams Pitt Southeby's Realty

## COMING SOON

The LockWorks: 329 units, 13,500 sf retail  
Robek's Smoothies  
First Niagara Bank  
Go Green Cleaners

- Integrates old and new creating a community with a singular historic ambience
- 1,000 residential units in a combination of new and historic buildings
- 330,000 square feet of retail opportunities
- Two blocks from I-95 and the Stamford Transportation Center containing Metro North Railroad, local and regional buses, and cab service
- Active shuttle service throughout Harbor Point, the Stamford Transportation Center and downtown Stamford
- LEED neighborhood development capturing the legacy of “The Lock City”

# YALE & TOWNE SITE PLAN



The legacy of Stamford's historic district, where Stamford earned the nickname "The Lock City", is being recaptured at Yale & Towne. The retail and residential space is designed with an eclectic blend of vintage and contemporary styles throughout the historic neighborhood. On the site of the old Yale Lock factory, residents and patrons will enjoy a "downtown" ambience with a NYC specialty grocer-anchored community that includes a South End shuttle service from Metro North Train Station, restaurants with outdoor dining, convenience services for residents, and a diverse selection of retail shops.

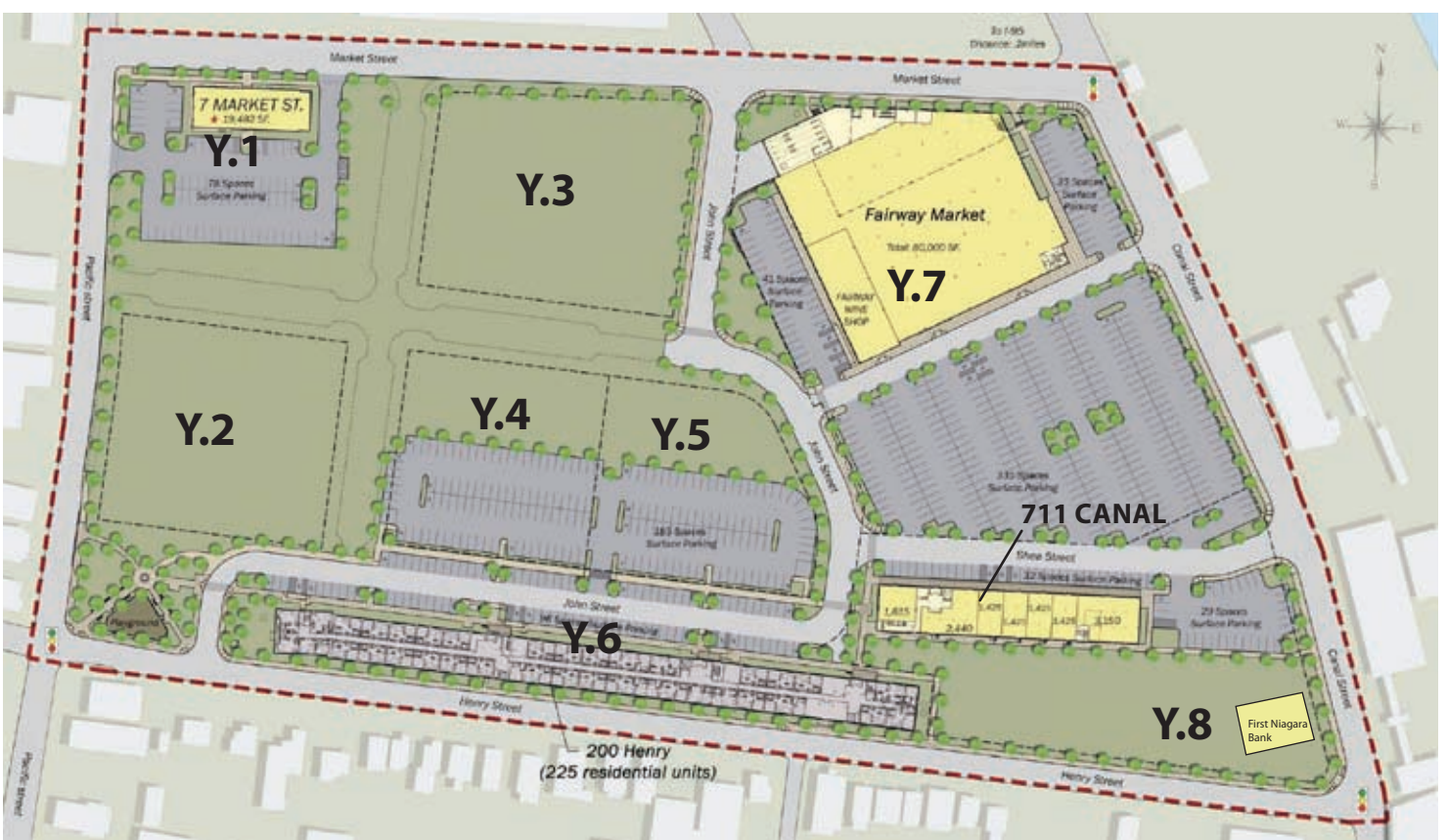

**Y.1:** Retail & Office | 19,482 sf & Hotel site

**Y.2-Y.5:** Residential/Retail | 329 residential units and 13,500 sf retail

**Y.6:** The Lofts at Yale & Towne | 225 residential units 100% leased

**Y.7:** Fairway Market and Fairway Wine & Spirits | 90,000 sf

**Y.8:** 711 Canal Street | Historic Retail & Office Building | New tenants include Design Within Reach, Robek's and First Niagara Bank

# THE LOCKWORKS SITE PLAN

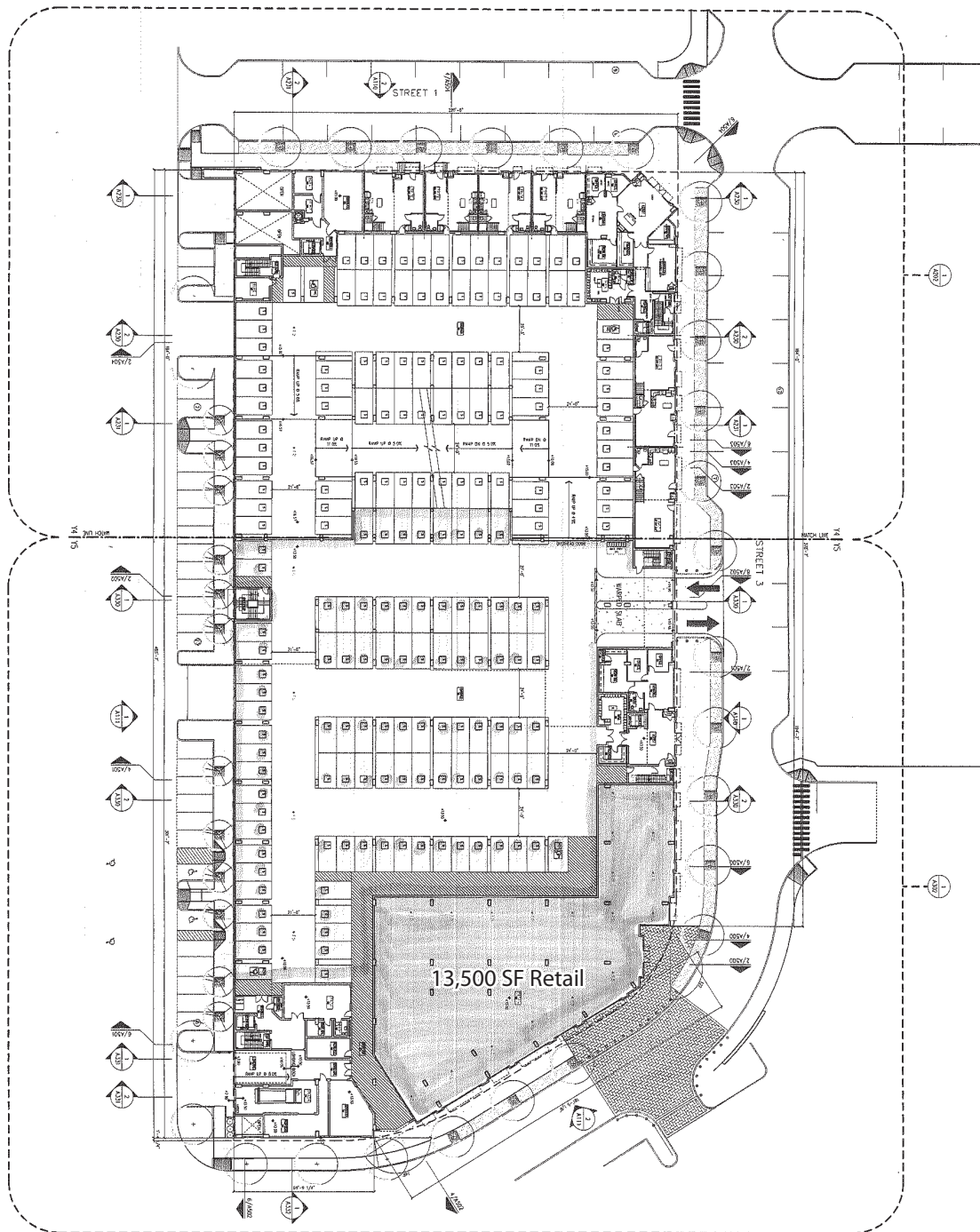

# THE LOCKWORKS FLOOR PLAN

